



Notes:

All measurements are indicative and must be confirmed on-site.

Do not scale from this drawing.

All electrical works must comply with:

BS 7671:2018 Amendment 2:2022

- IET Code of Practice: Electric Vehicle Charging Equipment Installation (4th Edition)
- The feeder pillar elevation is an approximate representation of the electrical layout and may differ from the actual installation.

All components, must be supplied and installed by others.

This design assumes the existing earthing arrangement is Protective Multiple Earthing (PME), which must be confirmed by the DNO prior to works being undertaken.

Title:

Feeder Pillar Elevation Drawing,
Three Phase 12 Way Distribution
Board

43 Swan Street, West Malling, Kent, ME19 6HF

email: plugmein@fulltothebrim.com | phone: 020 7097 5911

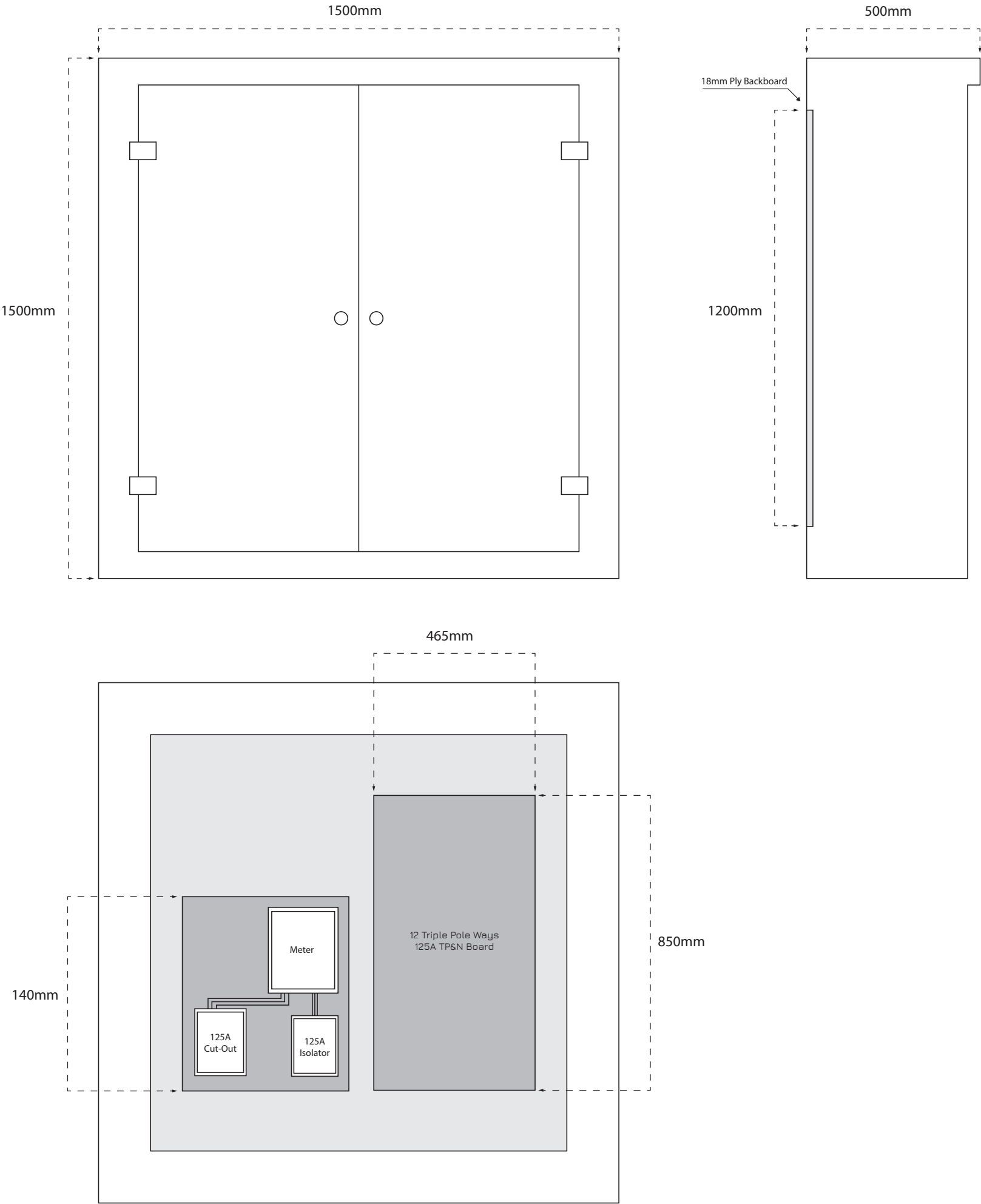



Notes:

All measurements are indicative and must be confirmed on-site.

Do not scale from this drawing.

All electrical works must comply with:

BS 7671:2018 Amendment 2:2022

- IET Code of Practice: Electric Vehicle Charging Equipment Installation (4th Edition)
- The feeder pillar elevation is an approximate representation of the electrical layout and may differ from the actual installation.

Pillars to be supplied by Brim. All other components must be supplied and installed by others.

This design assumes the existing earthing arrangement is Protective Multiple Earthing (PME), which must be confirmed by the DNO prior to works being undertaken.

Title:

Brim Chargers 7.4kWh Single Pillar Drawing

43 Swan Street, West Malling, Kent, ME19 6HF

email: plugmein@fulltothebrim.com | phone: 020 7097 5911

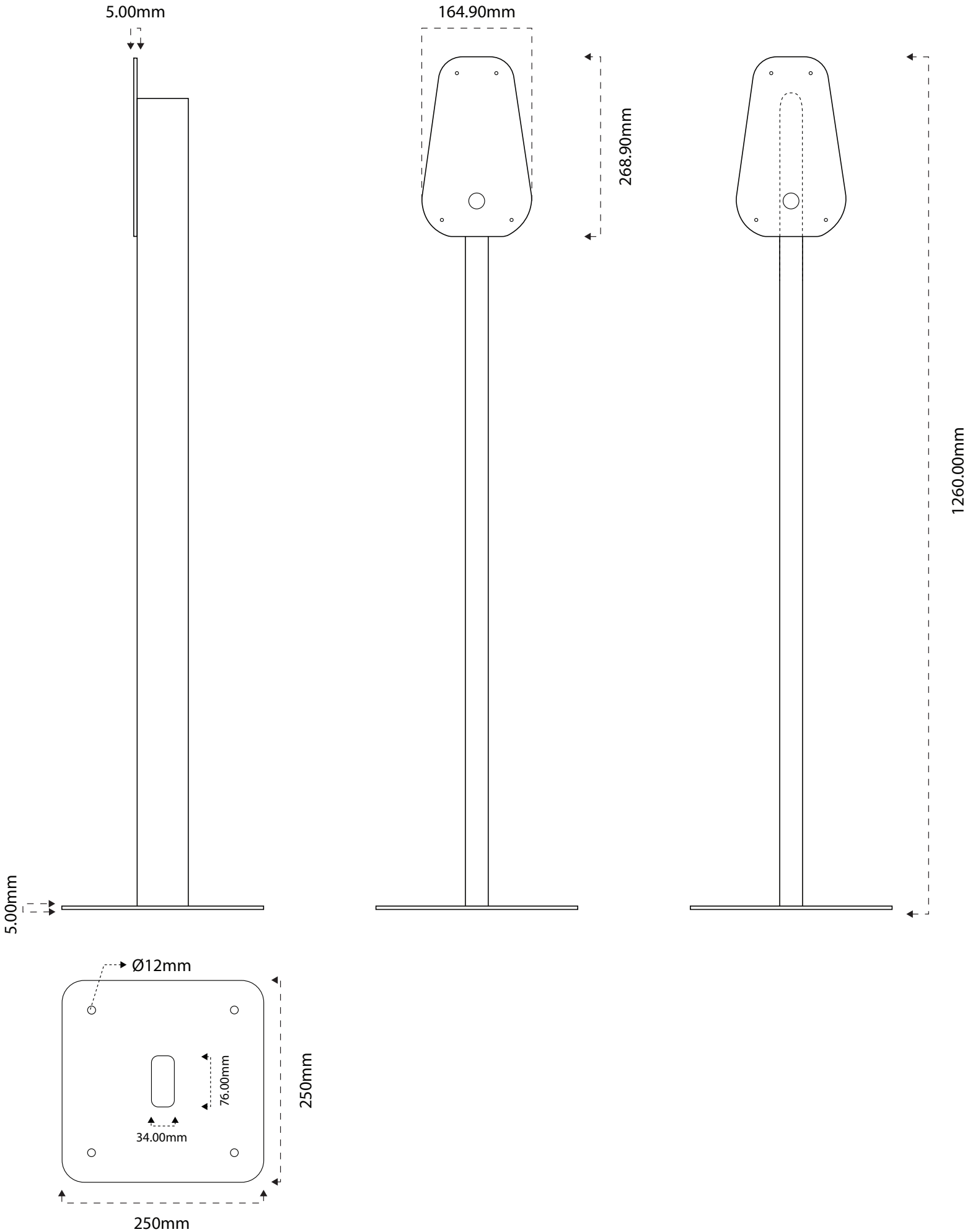



Notes:

All measurements are indicative and must be confirmed on-site.

Do not scale from this drawing.

All electrical works must comply with:

BS 7671:2018 Amendment 2:2022

- IET Code of Practice: Electric Vehicle Charging Equipment Installation (4th Edition)
- The feeder pillar elevation is an approximate representation of the electrical layout and may differ from the actual installation.

Pillars to be supplied by Brim. All other components must be supplied and installed by others.

This design assumes the existing earthing arrangement is Protective Multiple Earthing (PME), which must be confirmed by the DNO prior to works being undertaken.

Title:

Brim Chargers 7.4kWh Dual Pillar Drawing

43 Swan Street, West Malling, Kent, ME19 6HF

email: plugmein@fulltothebrim.com | phone: 020 7097 5911

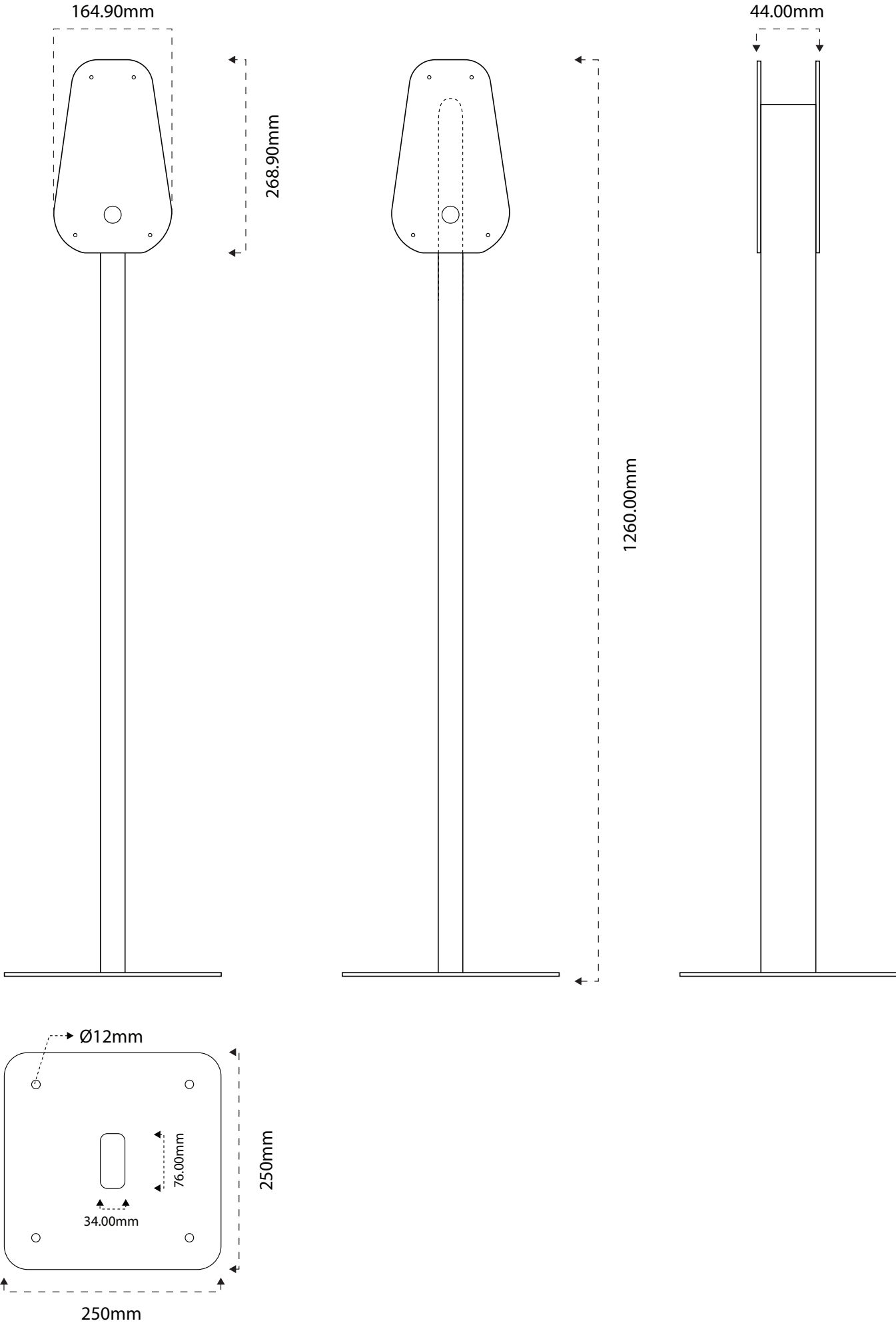

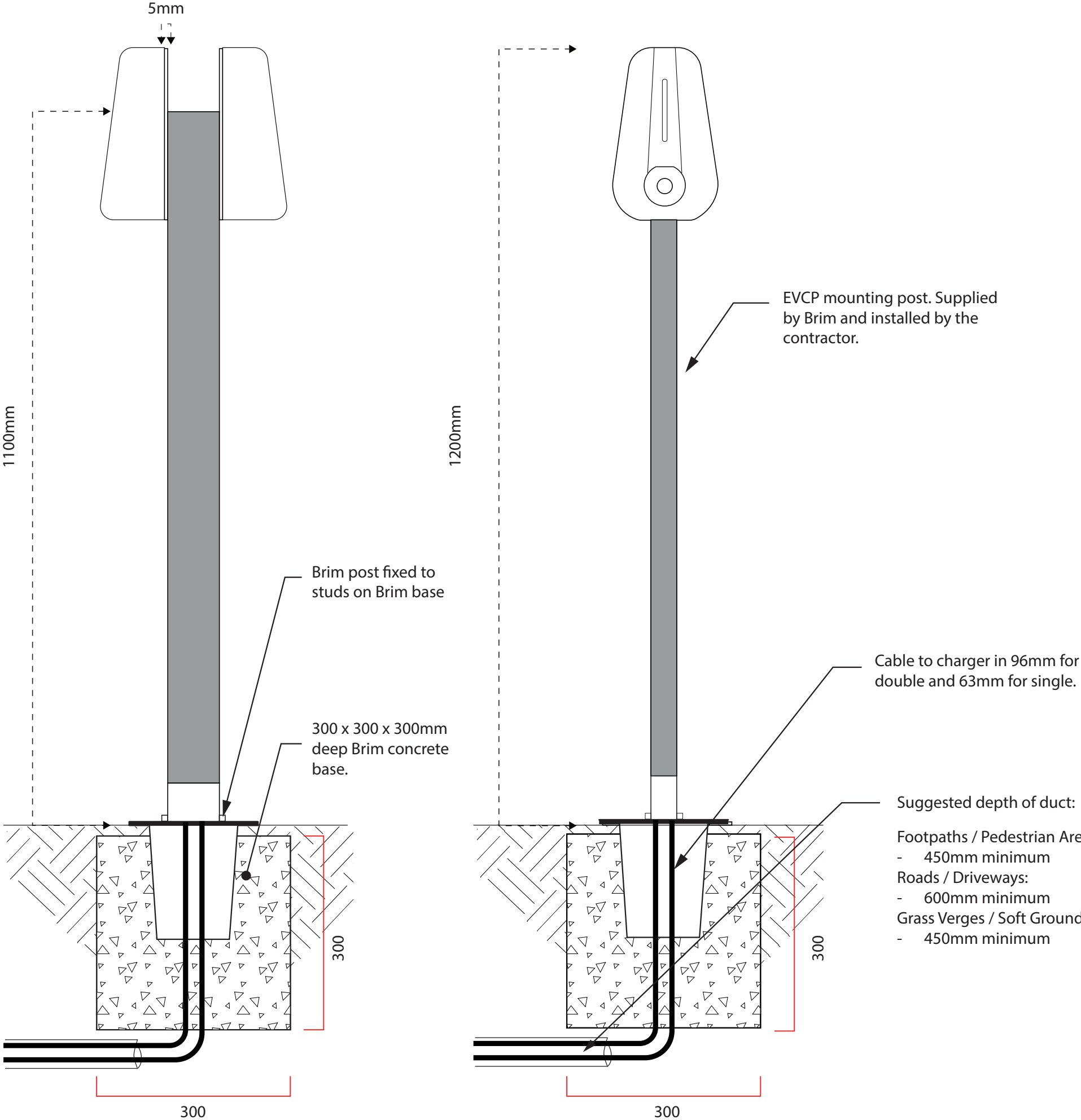

Notes:

All measurements are indicative and must be confirmed on-site.

Do not scale from this drawing.

All electrical works must comply with:

BS 7671:2018 Amendment 2:2022

- IET Code of Practice: Electric Vehicle Charging Equipment Installation (4th Edition)
- The feeder pillar elevation is an approximate representation of the electrical layout and may differ from the actual installation.

Pillars to be supplied by Brim. All other components must be supplied and installed by others.

This design assumes the existing earthing arrangement is Protective Multiple Earthing (PME), which must be confirmed by the DNO prior to works being undertaken.

Title:

Concrete Pad Schematic Drawing

43 Swan Street, West Malling, Kent, ME19 6HF

email: plugmein@fulltothebrim.com | phone: 020 7097 5911